

Multimode Gateway

Support multiple protocols: Zigbee 3.0 / BLE / BLE Mesh



Parameter

Product Name: Multimode Gateway (Zigbee 3.0 / BLE / BLE Mesh)

Model No.: ZB-Box3

Input: 5V 1A (Type-C)

Work Temperature: -10~40°C

Wireless Technology: Wi-Fi IEEE 802.11b/g/n 2.4GHz Zigbee 802.15.4 , Bluetooth 5.0

Max connected device: 128pcs

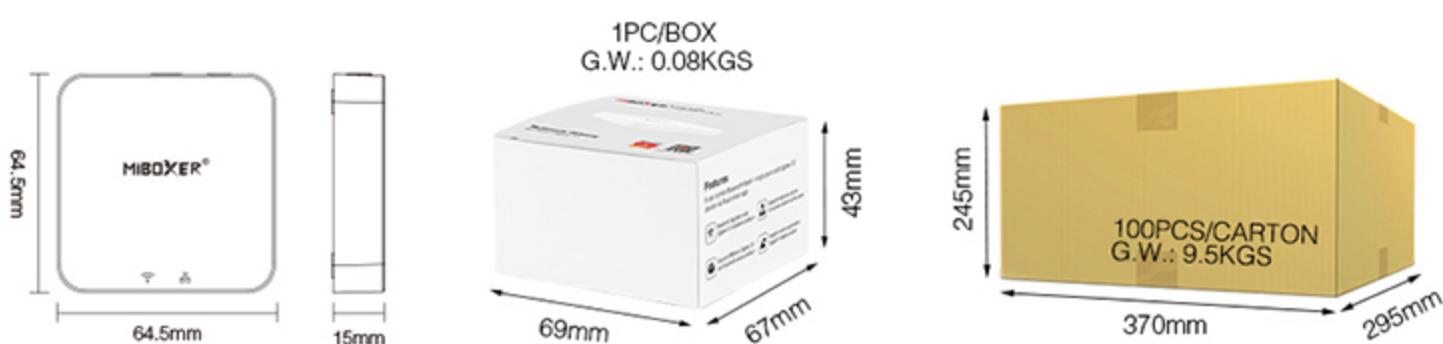

Zigbee 3.0



Bluetooth 5.0



Smart Linkage



APP remote control

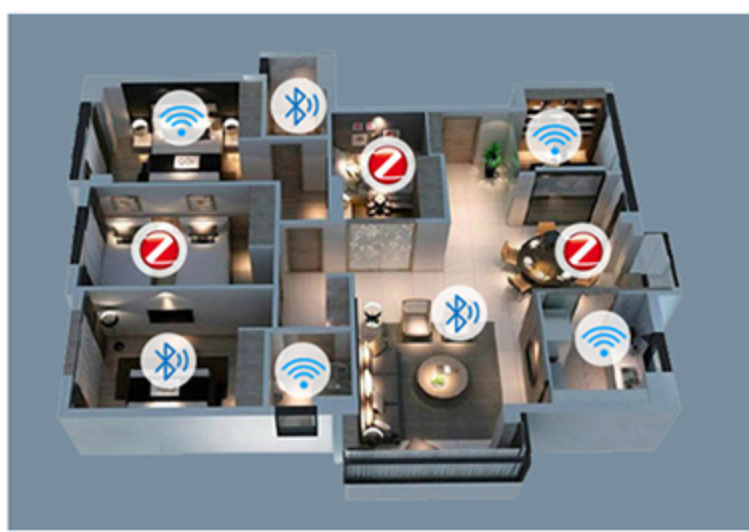

APP remote control all devices

Multi-mode gateway can control Zigbee and Bluetooth devices separately.

Compatible with MiBoxer series Zigbee3.0 products

It can be used with Zigbee lamps, controllers, PIR Sensor and other devices to experience more functions.

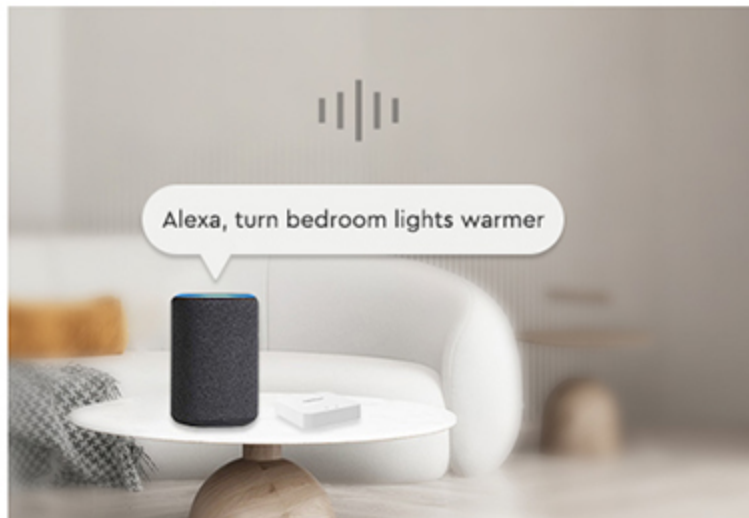

Support third party voice control



Connection Steps

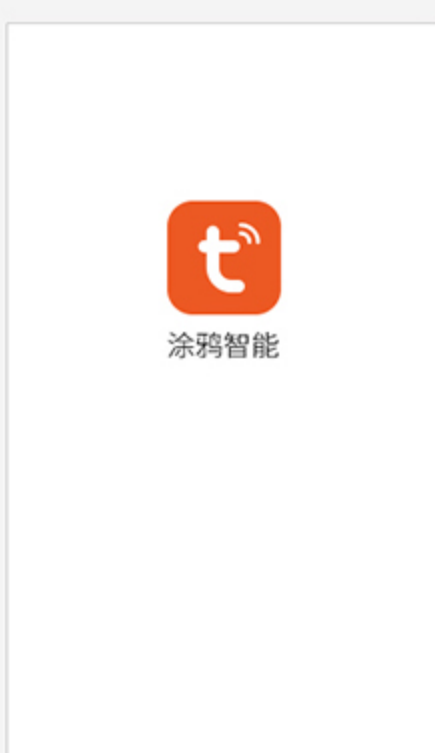

Steps 1
Download " Tuya Smart " app

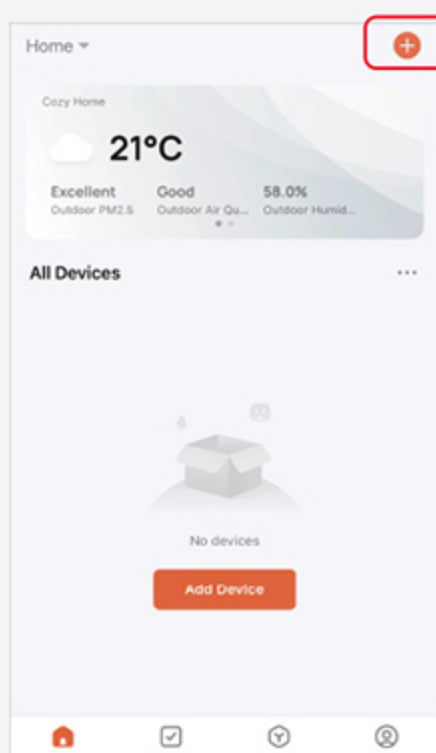

Steps 2
On the home page, touch " + " icon in the upper right corner



Steps 3
Touch " Gateway Control " to select " Wireless Gateway (BLE) "

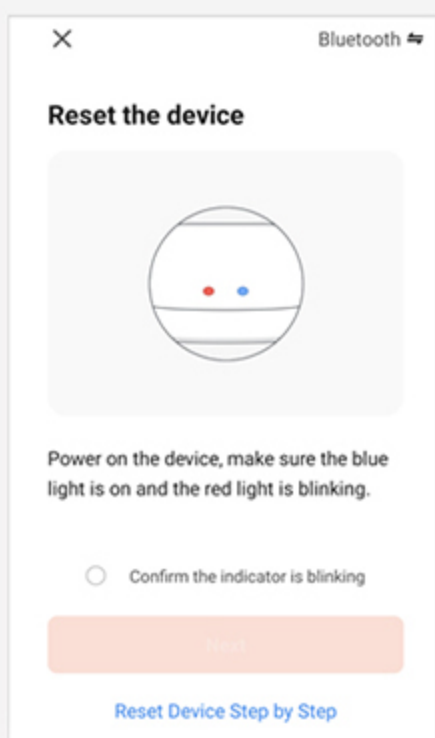

Steps 4
The gateway indicator flashes red, if not, press and hold the " SET " button for 5 seconds

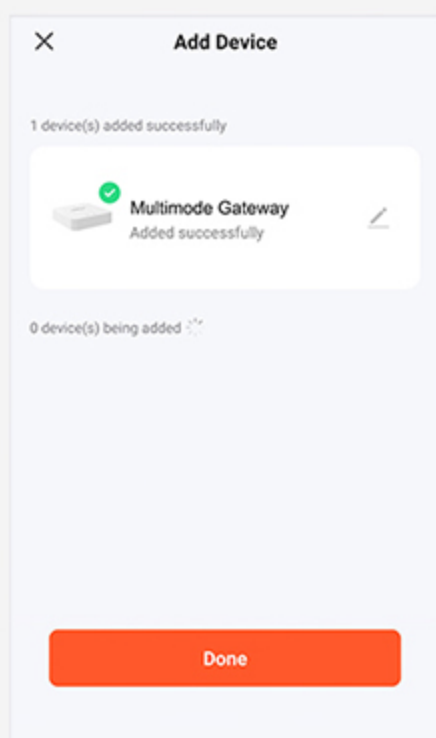

Steps 5
The gateway completes the match, touch " Done "

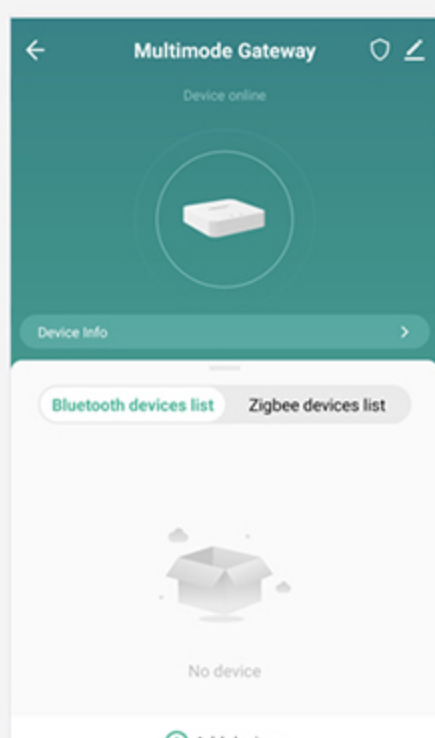

Steps 6
Touch " Add sub-device " to match the device